

- Video transmission over twisted pair cable
- Up to 1500m (4921ft) with UTP Cat.5 cable
- Vac or Vdc power supply
- Wide range of versions

The video transmission system over twisted pair consists in a transmitter and a receiver. The transmitter converts the composite video signal from a camera and transmit it over twisted pair, then the receiver converts again the signal in composite video. Both devices can be adjusted allowing amplification and equalisation of the signal then it is possible to cover long distances (up to 1500m for a colour video signal with UTP Cat.5 cable).

A wide range of models is available satisfying any installation requirements. The transmitter is normally supplied in a IP56 enclosure for outdoor installation: available in two versions, 12Vdc/24Vac TWT1 and 230Vac, 50Hz TWT1A. A mini version TWM1 is also available, fed in low voltage, for installation in the outdoor camera housing. The receivers are normally supplied in a IP56 enclosure for outdoor installation: low voltage version TWRB1 12Vdc/24Vac and high voltage TWRB1A 230Vac, 50Hz. The receiver is also available on Europe card TWRR1, fed in low voltage, for rack installation.

Il nuovo TWPL1 può portare il video l'alimentazione e la telemetria su un unico cavo cat. 5.

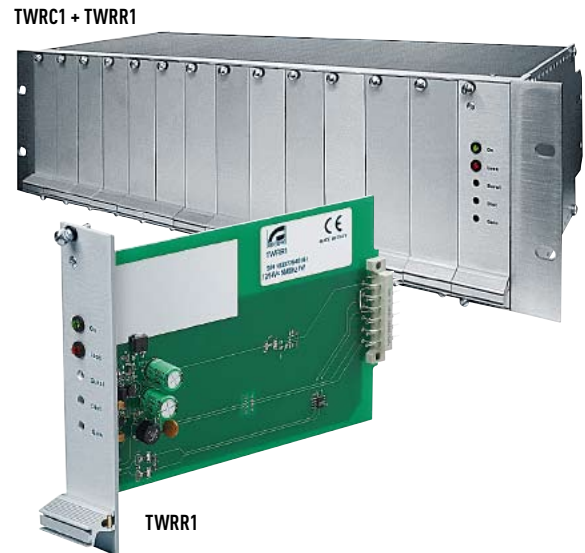
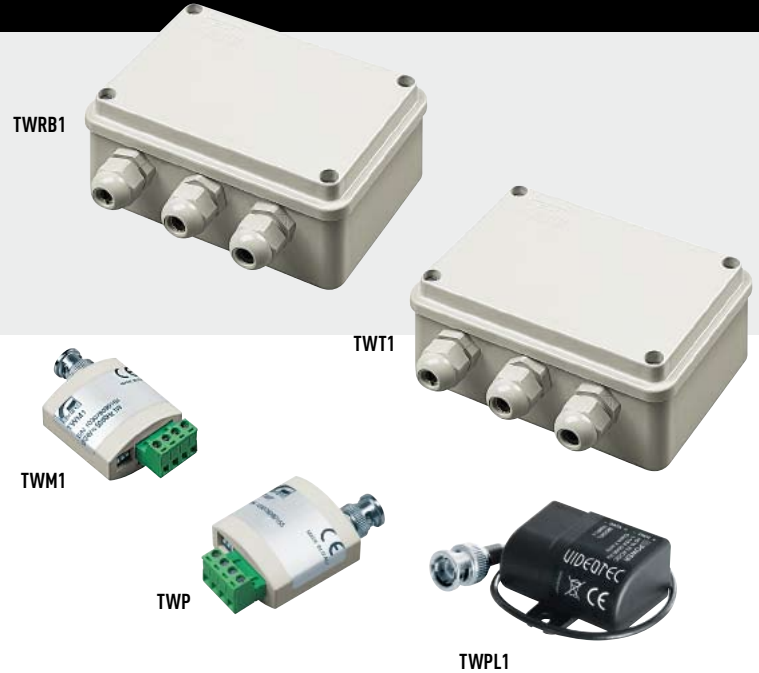

TWRB1

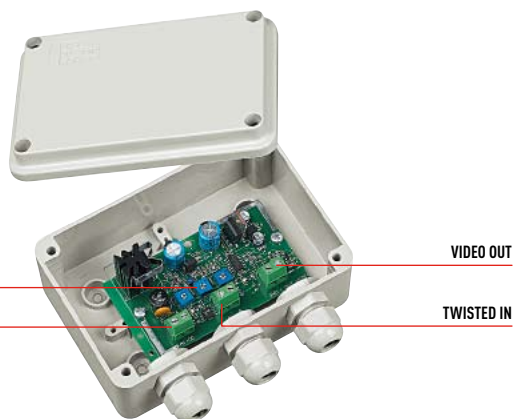

REGULATION TRIMMER

POWER IN

VIDEO OUT

TWISTED IN

TWRB1A

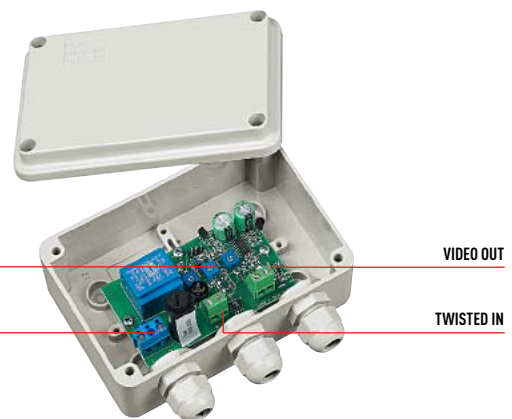

REGULATION TRIMMER

POWER IN

VIDEO OUT

TWISTED IN

TECHNICAL DATA

GENERAL

Immunity to ground loops
 Protection against over voltage
 Active transmitters: TWM1, TWT1, TWT1A
 Active receivers: TWRR1, TWRB1, TWRB1A
 Passive transmitter and receiver: TWP, TWPL1

Max distance with UTP Cat.5

Active transmitter and receiver
 - 1500m (4921ft) colour signal
 - 2000m (6561ft) white / black signal

Passive transmitter and receiver
 - 350m (1148ft) colour signal
 - 600m (1968ft) white / black signal

Passive transmitter TWP and receiver TWRR1, TWRB1, TWRB1A
 - 750m (2460ft) colour signal
 - 1250m (4101ft) white / black signal

Passive transmitter and receiver TWPL1
 - 100m (328ft) colour signal

Passive transmitter TWPL1 and active receiver TWR
 - 750m (2460ft) colour signal

Supplied with instruction manual

Retrofit on previous models: contact Videotec for further specifications.

MECHANICAL

TWP - TWM1
 Dimensions: 40x25x63mm (1.6x0.9x2.5in) connector not included

TWPL1
 Dimensions: 22x47x32mm (0.87x1.85x1.26in) connector and cable not included

TWT1 - TWRB1 - TWT1A - TWRB1A
 Plastic enclosure
 Dimensions: 129x89x58mm (5x3.5x2.3in) cable-glands not included

TWRR1
 Dimensioni: 3Ux6TEx190mm (7.5in) Eurocard

TWRC1
 Dimensions: 19", 3U/84TE

ELECTRICAL

Transmitter video input: 1.0Vpp, 75 Ohm
 Transmitter video output: 2x0.5Vpp
 Receiver video input: 0.05Vpp - 0.55Vpp
 Receiver video output: 1.0Vpp - 2.5Vpp
 Transmitter video output impedance: 110 Ohm
 Receiver video input impedance: 100 Ohm±10%
 Power supply TWT1 / TWM1 / TWRB1 / TWRR1: 12Vdc/24Vac
 Power supply TWT1A / TWRB1A: 230Vac
 Consumption max: 2W
 Power pass through TWPL1: 250mA at 300m, 1A at 30m on AWG24 cables
 Used cable UTP Cat.5 or above, 24AWG, 100 Ohm

COMMUNICATIONS

Ability to increase the distances using intermediate pairs of transmitters/receivers (in this case with recommend non exceeding 3/4 of the maximum distance for the individual sector)

With cable UTP Cat.5

TWRC1

Consumption: 30W

Power supply

- IN 100-240Vac - OUT 12Vdc, 47/63Hz, 2A

ENVIRONMENT

Indoor / Outdoor for TWT1, TWRB1, TWT1A and TWRB1A
 Indoor for TWRC1, TWP, TWPL1, TWM1 and TWRR1
 Operating temperature: -10°C / +50°C (14°F / 122 F°) for TWM1, TWT1, TWRB1, TWT1A e TWRB1A
 Operating temperature: -20°C / +75°C (-4°F / 167°F) per TWP
 Operating temperature for TWPL1: 0°C / + 85°C (32°F / +185°F)

COMPLIANCE TO

CE according to EN 61000-6-3, EN 60950, EN 50130-4
 TWT1, TWRB1, TWT1A and TWRB1A: IP56



Unit Weight:

TWM1 0.1kg / 0.2lb
 TWT1 / TWT1A 0.1kg / 0.2lb
 TWRB1 / TWRB1A 0.2kg / 0.4lb
 TWRR1 0.1kg / 0.2lb
 TWRC1 3kg / 6.6lb
 TWP 0.1kg / 0.2lb
 TWPL1 -

Package Weight:

TWM1 0.1kg / 0.2lb
 TWT1 / TWT1A 0.1kg / 0.2lb
 TWRB1 / TWRB1A 0.2kg / 0.4lb
 TWRR1 0.1kg / 0.2lb
 TWRC1 3.7kg / 8.2lb
 TWP 0.1kg / 0.2lb
 TWPL1 -

Package Dimensions (BxHxL):

TWM1 16.2x13x7cm / 6.3x5.1x2.8in
 TWT1 / TWT1A 16.2x13x7cm / 6.3x5.1x2.8in
 TWRB1 / TWRB1A 16.2x13x7cm / 6.3x5.1x2.8in
 TWRR1 22x14.5x4.6cm / 8.6x5.7x1.8in
 TWRC1 55x30x18cm / 21.6x11.8x7in
 TWP 16.2x13x7cm / 6.3x5.1x2.8in
 TWPL1

Master Carton:

TWM1 -
 TWT1 / TWT1A -
 TWRB1 / TWRB1A -
 TWRR1 -
 TWRC1 -
 TWP -
 TWPL1 -